



The Joint Meeting of  
The 36<sup>th</sup> annual ***Applied Geography Conference***

and

The 2013 annual meeting of  
Mid-Atlantic Division, Association of American Geographers

October 30, 2013 to November 1, 2013

## **CONFERENCE PROGRAM**

### **Sponsors**

Kent State University  
George Mason University  
Florida Atlantic University  
Texas State University – San Marcos  
Binghamton University  
University of North Texas  
Southern Illinois University Edwardsville  
ESRI, Inc.

Applied Geography Conferences website  
<http://applied.geog.kent.edu>

Middle Atlantic Division of A.A.G.  
<http://sites.google.com/site/>

# ***Applied Geography Conferences***

## **Board of Directors**

President, **Tom Dwyer**, Dutch Hill Consulting  
Executive Director, **Jay Lee**, Kent State University

### **MEMBERS**

**Dawna Cerney**, Youngstown State University  
**Phil Chaney**, Auburn University  
**Bradley Cullen**, University of New Mexico  
**Michael DeMers**, New Mexico State University  
**Richard Earl**, Texas State University – San Marcos  
**Tony Hernandez**, Ryerson University  
**Mark Hilderbrandt**, Southern Illinois University Edwardsville  
**Chris Laingen**, Eastern Illinois University  
**James Lein**, Ohio University  
**Rezaul Mohamood**, Western Kentucky University  
**Burrell Montz**, East Carolina University  
**Linda Peters**, ESRI, Inc.  
**Michael Ratcliffe**, US Census Bureau  
**Murray Rice**, University of North Texas  
**Richard Shaker**, Binghamton University  
**Wei Song**, University of Louisville

**Mid-Atlantic Division  
Of  
The Association of American Geographers**

**MAD Officers 2013:**

Chair: **Mark deSocio**, Salisbury University

Vice Chair: **Tracy Edwards**, Frostburg State University

Treasurer: **Karen DeLong**, Montgomery College

Secretary & Webmaster: **Alexis Aguilar**, Salisbury University

Awards Chair and Geography Bowl Coordinator: **Mark deSocio**

AAG Regional Division Councilor: **Jeremy Tasch**, Towson University

Past Chair: **Martha Geores**, University of Maryland, College Park

# CONFERENCE AT A GLANCE

## OCTOBER 30, 2013, WEDNESDAY

### Sessions W1, 1:30 pm – 3:00 pm

Census Panel: Census Bureau Data Visualization: Statistical Graphics and Mapping  
Water Resources I  
Remote Sensing I  
Geography Education I: Curriculum  
Urban Geography I: Environment

### Sessions W2, 3:30 pm – 5:00 pm

Climatology I: Climatic Variations in the USA  
Economic Geography I: Analysis and Policies  
GIS I: Online/Internet GIS  
Health Geography I: Geography of Diseases  
Urban Geography II: Development

### Session W3, 5:00 pm – 9:00 pm

#### Poster Presentations

### Session W4, 7:00 pm – 9:00 pm

#### Reception, Co-sponsored by George Mason University

Speaker: Liz Groff, Temple University, *Application of the research-practice dialogue in understanding and preventing crime: Tales from an applied geographer*

## OCTOBER 31, 2013, THURSDAY

### Sessions T1: 8:30 am – 10:00 am

Geography of Hazards I: Floods  
Remote Sensing II  
Ethnic and Racial Geography I  
Locational Intelligence I: Restaurants, Food, and Tourism

### Sessions T2: 10:30 am – 12:00 noon

Geography of Hazards II: Post Disasters  
GIS II: Spatial Analysis  
Ethnic and Racial Geography II  
Health Geography: Food and Environment  
Locational Intelligence II: Retail Chains and Markets

### Sessions T3: 1:30 pm – 3:00 pm

Geography of Hazards III: Preparedness  
Economic Geography II: Environment and Policies  
Ethnic and Racial Geography III  
Geography Education II: Teaching Methods  
Locational Intelligence III: Geography, Technology, and Business

**Sessions T4, 3:30 pm – 5:00 pm**

Climatology II: Urban Climatology and Health  
GIS III: Spatio-Temporal Analysis  
Ethnic and Racial Geography IV  
Physical Geography  
Locational Intelligence Panel: Future Directions in Locational Intelligence Research and Teaching

**Reception:** Co-sponsored by Kent State University

Featured John Frazier, Binghamton University, *Celebration of Career Paths in Applied Geography: A conversation with Ken Smith and Larry Carlson*

**NOVEMBER 1, 2013, FRIDAY**

**Sessions F1, 8:30 am – 10:00 am**

Water Resources II  
Census Bureau Applied Cartography and Mapping Products  
Remote Sensing III  
Geography Education III: Secondary Education  
Urban Geography III: Housing Issues

**Sessions F2, 10:30 am – 12:00 noon**

Climatology III: Regional Climatology  
Census Bureau Demographic and Geographic Analysis  
GIS IV: Transportation  
Urban Geography IV: Planning Issues  
Health Geography III: Regional Studies

**Luncheon, 12:00 pm – 2:00 pm**

Speaker: Michael Scott, Salisbury University and a Co-Presenter from the Maryland Governor's Office, *Reinventing Government by Applying Geography*

**Session F3, 2:30 pm – 3:40 pm**

Panel Session: Beyond the Ivory Tower - Applied Careers for Geographers

**Sessions F4, 3:50 pm – 5:00 pm**

Workshop: Preparing Geography Students for the 21st-Century Workforce  
Board of Directors Meeting

**WEDNESDAY, OCTOBER 30, 2013**

**REGISTRATION: 12:00 pm – 4:00 pm**

**SESSIONS W1: 1:30 pm – 3:00 pm**

## **PANEL SESSION**

*Room: Capitol A*

### **Census Bureau Data Visualizations: Statistical Graphics and Mapping**

**Moderator:** Michael Ratcliffe, Geography Division, Census Bureau

**Panelists: Overview**

Dierdre Bevington-Attardi, Geography Division, Census Bureau

**Data Visualizations of the Week**

Geoff Hatchard, Population Division, Census Bureau

**On The Map**

Matt Graham, Center for Economic Studies, Census Bureau

**Metro/Micro Map Census Tract Thematic Map**

Justyna Goworowska, Population Division, Census Bureau

**Census Data Mapper**

Meghan Smith, Geography Division, Census Bureau

**Dev3 Collaboration at the Census Bureau and Future Visions**

Marc Perry, Population Division, Census Bureau

## **WATER RESOURCES I**

*Room: Capitol B*

**Chair:** Christopher A. Badurek, Appalachian State University

### **The Hueco Bolson: A Case for Improved Transboundary Aquifer Management**

Lindsay Sansom, Texas A&M University, College Station

### **Stream Restoration and Hydrochory: Seed Pool Spatial Variation among Restored and Degraded Reaches Of The Kissimmee River, Florida**

Scott H. Markwith, Florida Atlantic University

### **Analysis of Impacts of Removing The Fort Loudon Dam On Upstream Residential Property Values In Tennessee**

Jeffrey C. French and Christopher A. Badurek, Appalachian State University

## **REMOTE SENSING I**

*Room: Capitol C*

**Chair:** Jennifer L. R. Jensen, Texas State University – San Marcos

### **Identifying Land-Use/Cover Change (1989 To 2009), And Recent Land-Use Patterns Using Remote Sensing And Gis On Kutubdia Island, Bangladesh**

Munshi Khaledur Rahman, Thomas Schmidlin, Mandy Munro-Stasiuk, and Andrew Curtis, Kent State University

### **Land Cover Versus Temperature In The Auburn-Opelika, Alabama Urban Area**

Andy Hug, Chandana Mitra, Yingru Li, and Luke Marzen, Auburn University

### **Lidar-Based Detection Of Shrubland And Forest Land Cover To Improve Identification Of Golden-Cheeked Warbler Habitat**

Jennifer L. R. Jensen, Sandra Irvin, and Adam Duarte, Texas State University - San Marcos

## **GEOGRAPHY EDUCATION I: CURRICULUM**

*Room: Senate A*

**Chair:** Richard G. Boehm, Texas State University – San Marcos

### **Connecting Compliance to the Curriculum: Mapping Stormwater Infrastructure And Pollution Through Undergraduate Community-Based Research And Service-Learning Program**

Jessica J. Kelly, Millersville University

### **Student Assessment of a GIS Internship Program in a Rural Setting**

Hyun Joong Kim, Pittsburg State University

### **Mapping Geographic Literacy in Texas**

Jeff Lash, University of Houston - Clear Lake

### **The Learning Cluster Model as a Means of Extending the Capabilities of an Online Professional Development System in Geography**

Carmen P. Brysch and Richard G. Boehm, Texas State University - San Marcos

## **URBAN GEOGRAPHY I: ENVIRONMENT**

*Room: Senate B*

**Chair:** Brooks C. Pearson, University of Central Arkansas



## **A Comparison of Forest Disturbance Based on Land Ownership and Topography in Conterminous United States, 2006-2010**

Riley Forsyth, South Dakota State University

## **A Contingent Valuation of Tampa's Urban Forest**

Alec Foster, Temple University and Graham A. Tobin, University of South Florida

## **Assessing the Impact of Forest Fragmentation Due to Natural Gas Development on Wild Turkey Nesting Success in Van Buren County, Arkansas**

Brooks C. Pearson, James K. Casey, M. Victoria McDonald, and Jerry Reynolds, University of Central Arkansas

## **The Spatial Implications of the Yamoransa-Mankessim Coastal Highway and Pedestrian Safety**

Erick K. Aikins, University of Cape Coast, ape Coast, Ghana

## **SESSIONS W2: 3:30 PM – 5:00 PM**

### **CLIMATOLOGY I: CLIMATIC VARIATIONS IN THE USA**

*Room: Capitol A*

Chair: John Harrington, Jr., Kansas State University

### **Precipitation Variability Trends in Texas, 1932-2011**

Rebecca Parylak, Kent State University and Richard W. Dixon, Texas State University  
- San Marcos

### **Tornado Vulnerability Variance over a 24-Hour Cycle for an Urban Metropolitan Region**

Marius Paulika, Kent State University

### **Communicating Kansas Climate and Climate Change: Initial Development of a Web-Based Resource**

Ram Raghavan and John Harrington, Jr., Kansas State University

### **ECONOMIC GEOGRAPHY I: ANALYSIS AND POLICIES**

*Room: Capitol B*

Chair: Richard Shaker, Binghamton University

### **Chinese FDI in the US: A State Level Analysis of the Geography of FDI and FDI Per Capita, 2012**

Jeremy Bennett and Jay D. Gatrell, Indiana State University

## **Incentivizing Economic Inclusion: Access to Financial Services in Underserved Areas**

Ian M. Dunham, Temple University

## **The Geographic Profile of an Economic Crisis**

Johannes Moenius, University of Redlands

## **The Sunshine State, GDP, and the DMSP-OLS - A Time Series Trend Case Study**

Dolores Jane Forbes, Florida Atlantic University

## **GIS I: ONLINE/INTERNET GIS**

*Room: Capitol C*

**Chair:** Arleen A. Hill, University of Memphis

## **Developing and Testing an Online Tool for Volunteered Geographic Information Collection**

David A. Parr and Michael Scholz, Texas State University - San Marcos

## **An Open Source Software Approach to Geospatial Sensor Network Standardization**

Andrew J. Rettig and Dan Heintzelman, University of Cincinnati, Sumit Khanna, University of Tennessee, and Richard A. Beck, University of Cincinnati

## **Prototype Global Coding of Political Geographies for Library and Data Management - Wikipedia Example**

Thomas J. Christoffel, FeRSA, Regional Intelligence-Regional Communities, LLC

## **GIS As a Platform for Regional Information Sharing in Emergency Management/Homeland Security**

Arleen A. Hill, Brian A. Waldron and Lauren E. Goddard, University of Memphis, and Robert D. Nations, Jr., Shelby County, Memphis, TN

## **HEALTH GEOGRAPHY I: GEOGRAPHY OF DISEASES**

*Room: Senate A*

**Chair:** Kent McGregor, University of North Texas

## **The Spatial Heterogeneity of Demographic Variables Associated with Male Suicide in the United States**

Andrew B. Trgovac and Sharmistha Bagchi-Sen, University of Buffalo – SUNY

## **Exploratory Spatial Data Analysis of Major Respiratory Diseases across Central Appalachia**

Timothy S. Hare, Chad Wells, Porsha Smith, and Nicole Johnson, Morehead State University

**Exploratory Space-Time Analysis of Dengue Incidence in Trinidad: A Retrospective Study, 1998-2004**

Ron Mahabir, George Mason University

**Coping with Meniere's Disease: Identification on Places with Fewest Weather Changes**

Kent McGregor, University of North Texas

**URBAN GEOGRAPHY II: DEVELOPMENT**

*Room: Senate B*

**Chair:** John R. Lombard, Old Dominion University

**Assessing Sustainable Urbanization across Europe: Application of *the Wellbeing of Nations index***

Richard R. Shaker and Sara L. Zubalsky, Binghamton University

**The Washington, D.C. Area 1790-1890: From Two Towns to A Growing Capital City**

Sinclair Sheers, George Mason University

**Measuring Temporal Displacement of Non-Violent Crime**

Vijayaprabha Rajendran and Falguni Mukherjee, Department of Geography and Geology, Sam Houston State University

**Regional Visioning: A Case Study of Capturing Public Preferences on Land Use Planning for the Future Using Legos and GIS**

John R. Lombard and George McLeod, Old Dominion University and Sara Kidd, Hampton Roads Planning District Commission, Chesapeake, Virginia

**SESSIONS W3: 5:00 PM – 9:00 PM**

**POSTER PRESENTATIONS**

**Assessing and Evaluating Environmental Literacy of University Freshmen**

Krystal Davis and Zachary Linn, Pittsburg State University

**Landscape Zonation Map Design in the Ecuadorian Amazon Using Geospatial Techniques**

Ophelia Wang, Northern Arizona University

Note: additional poster presentations will be added after the September deadline for entries.

**SESSIONS W4: 7:00 PM – 9:00 PM**

**OPENING RECEPTION**

Co-Sponsored by George Mason University

Speaker: Liz Groff, Temple University

**Application of the research-practice dialogue in understanding and preventing crime: Tales from an applied geographer**

**THURSDAY, OCTOBER 31, 2013**

**SESSIONS T1: 8:30 AM – 10:00 AM**

**GEOGRAPHY OF HAZARDS I: FLOODS**

*Room: Capitol A*

**Organizers:** Burrell A. Montz, East Carolina University and Graham A. Tobin, University of South Florida

**Chair:** Burrell A. Montz, East Carolina University

**Non-Authoritative Data for Flood Disaster and Road Infrastructure Assessment**

Emily Schnebele, George Mason University, G. Cervone, Pennsylvania State University, C. Oxendine, U.S. Military Academy, and N. Waters, George Mason University

**Communicating Flood Risk: Getting Our Act Together**

Michael S. Scott, Salisbury University

**GIS Application for Jakarta Flood Evacuation Planning Using Network Analyst**

M. Ramdhani Fajri, Mia Renaully, and Fathu Rohmah, Universitas Indonesia

**Record Flooding, Levee Certification, and Mapping: A Case Study of Floodplain Designation Issues in New York**

Burrell A. Montz and Christine Gares, East Carolina University

**REMOTE SENSING II**

*Room: Capitol B*

**Chair:** Janet Gritzner, South Dakota State University

**Remote Sensing of Evapotranspiration in Florida Using Dry Pixel Calibration**

Aaron Evans, Florida Atlantic University

**Validation of the Everglades Depth Estimation Network (EDEN) Water-Surface Model**

Zixiao Xie, Florida Atlantic University, Zhongwei Liu, Indiana University of Pennsylvania, and Yingru Li, Auburn University

**A Remote Sensing Based Study on Silt Deposition in Meghadrigedda Reservoir, Visakhapatnam, India**

P. Jagadeeswara Rao and G. Ashenafi Tolessa, Andhra University, Visakhapatnam, India (*withdrawn*)

## **Deriving Measures and Profiles of Wetland Feature from LAS Datasets**

Janet Gritzner and Bruce V. Millett, South Dakota State University

## **ETHNIC AND RACIAL GEOGRAPHY I**

*Room: Capitol C*

**Organizers:** John W. Frazier and Jay Newberry, Binghamton University

**Chair:** John W. Frazier, Binghamton University

## **Considering the Heritage of Place in Consultation with Indigenous Peoples**

Roxanne T. Ornelas, Miami University, Ohio

## **Socioeconomic Effects of Gaming Casinos on Native American Reservations**

Lauren Burns and Norah F. Henry, Binghamton University

## **Cultural Geographies of Dearborn, Michigan**

William Louie Kiskowski, Kent State University

## **Population Change among Aboriginal Canadians: 1996-2006**

James C. Saku, Frostburg State University

## **LOCATIONAL INTELLIGENCE II: RESTAURANTS, FOOD, AND TOURISM**

*Room: Senate B*

**Chair:** Tony Hernandez, Ryerson University, Canada

## **Applications of Gravity Modeling to Evaluate Dine-In Restaurant Location and Competitiveness Using a Representative Sample, Jefferson County, Kentucky**

Joel P. Dock and Wei Song, University of Louisville

## **Retail Change and Light Rail: An Analysis of Restaurant and Retail Location Changes Associated with Transit Station Development in Denton, Texas**

Trevor Yarbrough and Murray D. Rice, University of North Texas

## **Marketing American Microbrews: Promoting Neolocalism One Map at A Time**

Matthews T. Pattern and Adam J. Mathews, Texas State University - San Marcos

## **Taste Paradise: Tropical North Queensland As A Gastronomic Tourism Destination**

Deborah Che, Southern Cross University, Rose Wright, Knowledge Transfer Services Pty Ltd., and Robyn Rae, Queensland Department of State Development, Infrastructure and Planning, Australia

**SESSIONS T2: 10:30 AM – 12:00 NOON**

## **GEOGRAPHY OF HAZARDS II: POST DISASTERS**

*Room: Capitol A*

**Chair:** Graham A. Tobin, University of South Florida

### **Geographic Differences in Emergency Management Decision-Making: A Case Study of Severe Weather in the Midwest**

Holly Lussenden, East Carolina University

### **Hazard Characterization of Induced Seismicity in Eastern Ohio: A Hydraulic Fracturing Investigation**

James Lein, Ohio University

### **Post-Katrina Population Loss and Uneven Recovery in New Orleans 2000-2010**

Fahui Wang, Department of Geography and Anthropology, Quan Tang, Department of Geography and Anthropology and ESRI, Inc., and Lei Wang, Department of Geography and Anthropology, Louisiana State University

### **Networks of Place, Places of Networks: How Disaster-Affected Villages and Resettlements Are Connected and Separated through Aggregates of Personal Support Networks**

Graham A. Tobin, University of South Florida, Eric C. Jones, University of North Carolina Greensboro, A. J. Faas, North Carolina University, Arthur D. Murphy, University of North Carolina Greensboro, Chris McCarty, University of Florida, and Linda M. Whiteford, University of South Florida

## **GIS II: SPATIAL ANALYSIS**

*Room: Capitol B*

**Chair:** Ronald Wilson, US Department of Housing and Urban Development

### **A GIScience Approach to Urgent Care Facility Site Selection in Nebraska**

Paul Burger, University of Nebraska at Kearney, Brett Chloupek, Northwest Missouri State University, and H. Jason Combs, University of Nebraska at Kearney

### **GIS Analysis of Power Plant Carbon Dioxide Emission Inventory Database in the Continental United States**

Maya G. Hutchins and Christopher A. Badurek, Appalachian State University

### **Identifying Potential Hotspots of Conflict between Wildlife and NTFP Harvesters Using Spatial Analysis: A Case Study of Intersecting Florida Black Bear Habitat and Saw Palmetto Berry Harvesting**

Christine Mitchell, Florida Atlantic University

## **Transforming Data to Improve the Thematic Mapping of Regional Racial Segregation Patterns**

Ronald Wilson, US Department of Housing and Urban Development and University of Maryland, Baltimore County

## **ETHNIC AND RACIAL GEOGRAPHY II**

*Room: Capitol C*

**Organizers:** John W. Frazier and Jay Newberry, Binghamton University

**Chair:** Jay Newberry, Binghamton University

### **Mapping Political Segregation in the Metropolis: Non-Spatial and Spatial Measures**

Charlie H. Zhang, University of Louisville

### **Somali Secondary Migrations: An Analysis of Locational Determinants**

Jay Newberry, Binghamton University

### **Disparities in the US Census Racial Categories and the Population's Perception of Race: The Case of Puerto Rico**

Ana I. Sanchez-Rivera, Binghamton University

### **The Status of Women in Senegal: A Comparative Analysis among Predominantly Muslim Countries in Africa**

Yasmin Diallo Turk, Texas State University - San Marcos

## **HEALTH GEOGRAPHY II: FOOD AND ENVIRONMENT**

*Room: Senate A*

**Chair:** Stacey R. Brown, Southern Illinois University Edwardsville

### **Area Disparities of Obesity, Non-Fresh Food Outlets, and Fitness Centers**

Jay Lee, Mohammad Al Nasrallah, Kent State University, Everett Logue, Summa Health System, Ohio, and Heather Beard, Kent State University

### **The Location of an Organic Food Store in Western New York State**

Patrick Callahan, Binghamton University

### **Delineating Urban Food Deserts with GIS at Nashville, Tennessee: 2003-2013**

David A. Padgett, Tennessee State University (*withdrawn*)

### **The Price is Right? Food Availability and Affordability in Oklahoma City**

Stacey R. Brown, Southern Illinois University Edwardsville



## **LOCATIONAL INTELLIGENCE II: RETAIL CHAINS AND MARKETS**

*Room: Senate B*

**Chair:** Lawrence Joseph, Arizona State University

### **Modeling Retail Chain Expansion through Wave Analysis**

Lawrence Joseph, Arizona State University

### **Can You Really Walk There from Here? A Case Study of Walkability at Mockingbird Station in Dallas, Texas**

Owen Wilson-Chavez and Murray D. Rice, University of North Texas

### **Changes in Consumer Behavior during the Great Recession: A Spatio-Temporal Analysis Using Retail Data**

Xin Zhao, University of Redlands

### **Examining the Impact of Spatial Measures on Residential Property Prices in the Toronto Region**

Maurice Yeates, Tony Hernandez, and Paul Du, Ryerson University, Canada

## **SESSIONS T3: 1:30 PM – 3:00 PM**

## **GEOGRAPHY OF HAZARDS III: PREPAREDNESS**

*Room: Capitol A*

**Chair:** Philip L. Chaney, Auburn University

### **Safe Travels? An Examination of the Search and Rescue Policies and Capabilities in the Northwest Passage Region**

David Schwartz, California State University Long Beach

### **Animal Evacuations during Wildfires: An Oklahoma Case Study**

Breanna Shunn, Oklahoma State University

### **Vulnerability Assessment of Tropical Cyclones in Coastal Rangeland**

Istiak A. Bhuayn and Thomas Linsenmeyer, Towson University, Nashid Kamal Khadem, University of Dhaka, and Kang Shou Lu, Towson University

### **Mobile Home Resident Preparedness for Tornado Hazards: The 2011 Disaster in Dekalb County, Alabama**

Philip L. Chaney, Greg S. Weaver, Susan A. Youngblood, Kristin Pitts, and Alyson Cederholm, Auburn University

## **ECONOMIC GEOGRAPHY II: ENVIRONMENT AND POLICIES**

*Room: Capitol B*

**Chair:** Catherine A. Hooey, Pittsburg State University

### **Eagle Ford Shale Production: Infrastructure Effects in Lasalle County and Cotulla, TX, USA**

Stacey L. Allbritton and Donald J. Huebner, Texas State University - San Marcos

### **The Economic Importance of Hunting in Southwestern Montana**

Ryan D. Bergstrom, Gustavus Adolphus College and Shannon V. Taylor and Katherine J. Hanson, Montana State University

### **"Galamsey" Redefined: Counting the Social and Environmental Cost of the New Rush for Ghana's Gold and the Implications for Sustainable Local Development**

John Boakye-Danquah, United Nations University, Japan

### **The Impacts of Natural Revegetation of Abandoned Mine Land on Changing Land Use Patters in Southeast Kansas**

Catherine A. Hooey and Timothy J. Bailey, Pittsburg State University

## **ETHNIC AND RACIAL GEOGRAPHY III**

*Room: Capitol C*

**Organizers:** Jay Newberry and John W. Frazier, Binghamton University

**Chair:** David H. Kaplan, Kent State University

### **The Redistribution of Puerto Ricans in New York: Contemporary Settlement Patterns and Socioeconomic Status, 2010**

Jennifer Hinojosa, University of Maryland

### **Is It Really Worth It? Polish Labor Migrants to London, UK**

Weronika Kusek, Kent State University

### **Asian Indians and the Transformation of Queens Neighborhoods: The Need for Conflict Resolution**

John W. Frazier and Brendan McGovern, Binghamton University

### **Geo-Demophysycography of Global War on Terrorism**

Dhaniswara Wiradharma and Eva Sari Tampubolon, University of Indonesia, Indonesia

## **GEOGRAPHY EDUCATION II: TEACHING METHODS**

*Room: Senate A*

**Chair:** Paporn Thebpanya, Towson University

### **Integrating Geospatial Technology across University Environmental Science Courses**

Emariana Taylor, Kent State University

### **Promoting High-Level Geographic Learning with Clickers**

Yu Zhou, Bowling Green State University

### **Relating Girls and Science: Increasing Geography/STEM Interest in Rural High School Girls in Kansas**

Lisa K. Tabor and Lisa M. B. Harrington, Kansas State University

### **The Implementation of GIS Secondary Education in the State of Maryland**

Paporn Thebpanya and Heather Holst, Towson University

## **LOCATIONAL INTELLIGENCE III: GEOGRAPHY, TECHNOLOGY, AND BUSINESS**

*Room: Senate B*

**Chair:** Murray D. Rice, University of North Texas

### **Longitudinal Examination of Business Clustering in Knowledge-Based Industries in the Austin Metropolitan Statistical Area, 2007 to 2012**

Eric Clennon, R. Denise Blanchard, and Edwin T. Chow, Texas State University - San Marcos

### **Localism and American Broadcasting in the Age of Satellite Television**

Jonathan C. Comer and Thomas A. Wikle, Oklahoma State University

### **How LinkedIn is corporate America? A Geographic Analysis of LinkedIn Social Network Participation among Fortune 500 Firms and Their Employees**

Murray D. Rice, University of North Texas

**SESSIONS T4: 3:30 PM – 5:00 PM**

## **CLIMATOLOGY II: URBAN CLIMATOLOGY AND HEALTH**

*Room: Capitol A*

**Chair:** Mark L. Hildebrandt, Southern Illinois University Edwardsville

### **Characterization of the Urban Heat Island Intensity within Jefferson County, Kentucky**

Jeremy Sandifer, University of Louisville

### **Measuring the Relationship of Various Climate Change-Related Variables and Contextualizing Its Interaction in the Caribbean Region**

Harrison W. Flores-Ortiz, Texas State University - San Marcos

### **Analysis of Ground-Level Ozone in Granite City, Illinois during Late Summer 2012**

Mark L. Hildebrandt and Alex McBride, Southern Illinois University Edwardsville

### **Area Vulnerability of Pneumonia Caused by Climate Change in Padang City, West Sumatera Province, Indonesia**

Ajeng Dewi Andini and Nur Mufidatunnisa, Department of Geography, University of Indonesia, Indonesia

## **GIS III: SPATIO-TEMPORAL ANALYSIS**

*Room: Capitol B*

**Chair:** Chris Laingen, Eastern Illinois University

### **Spatial Accessibility of Public Universities in Texas**

Kanika Verma, Nathaniel Dede-Bamfo, and Edwin T. Chow, Texas State University - San Marcos

### **Visualizing Neighborhood Development through a Historical GIS Lens: A Pedagogical Approach**

Greg Rybarczyk, University of Michigan – Flint

### **A Geo-Temporal Analysis of the Conservation Reserve Program: Net vs. Gross Change, 1986-2013**

Chris Laingen, Eastern Illinois University

## **ETHNIC AND RACIAL GEOGRAPHY IV**

*Room: Capitol C*

**Organizers:** Jay Newberry and John W. Frazier, Binghamton University

**Chair:** Charlie H. Zhang, University of Louisville

## **Towards a Concept of a Polyethnic Neighborhood**

David H. Kaplan, Kent State University

## **Clustering with Visibility and Invisibility: Towards and Understanding Ethnic Clustering by the Same Ethnic Group in Different Locations**

John W. Frazier and Kevin Heard, Binghamton University

## **Cultural Transmission of the Tamil Diaspora: A Case Study of Cleveland, Ohio**

Christabel Devadoss, Kent State University

## **Chinatown, Ethnoburg, Or Invisiburb? Changing Settlement Patterns of Chinese Migrants to Texas**

Melissa Holmes and Sara Blue, Texas State University - San Marcos

## **Uyghur Muslim Minorities: From Mao to Present**

Syed S. Uddin-Ahmed, St. John's College of Liberal Arts and Sciences, New York

## **PHYSICAL GEOGRAPHY**

*Room: Senate A*

**Chair:** Steve Jennings, University of Colorado Colorado Springs

## **Historical Channel Change of Vermillion Creek, Kansas, USA, Between 1927 and 2012**

Rhett L. Mohler, Saginaw Valley State University

## **Predicting Pumice Raft Trajectories**

Michael R. Bender, Pennsylvania State University and NASA Develop National Program

## **Vulnerability of Kuwait Coast to Sea-Level Rise**

Mohammad M. M. Alsahli and Ahmed M. AlHasem, Kuwait University, Kuwait

## **Forest Changes on Pikes Peak, Colorado, as Interpreted through Repeat Photography**

Steve Jennings, University of Colorado Colorado Springs

## **LOCATIONAL INTELLIGENCE PANEL: FUTURE DIRECTIONS IN LOCATIONAL INTELLIGENCE RESEARCH AND TEACHING**

*Room: Senate B*

**NOVEMBER 1, 2013**

**SESSIONS F1: 8:30 AM – 10:00 AM**

**WATER RESOURCES II**

*Room: Capitol A*

**Chair:** Richard A. Earl, Texas State University – San Marcos

**Inundation Patterns and Plant Growth in Constructed Wetland Characterized by Dynamic Water Budget Model**

Paul Hudak, University of North Texas

**Investigating Aquatic Invasive Species Propagation within the Adirondack Region of Northern New York**

Richard R. Shaker and Charles Rapp, Binghamton University

**Comparative Analysis of Attitudes towards Water Management Decision-Making in Western North Carolina**

Christopher A. Badurek, Robin Hale, Kristan Cockerill, Appalachian State University

**The Edwards Aquifer and Changes in the San Antonio, Texas Water Supply, 1993-2013**

Richard A. Earl, Texas State University - San Marcos

**CENSUS BUREAU APPLIED CARTOGRAPHY AND MAPPING PRODUCTS**

*Room: Capitol B*

**Organizer and Chair:** Michael Ratcliffe, Geography Division, Census Bureau

**Accessing Census Bureau Data Prejoined with TIGER/Line Shapefiles**

Thomas Morton, U.S. Census Bureau

**Census Flow Mapper: A New Mapping Application for County-to-County Migration Flows**

Ryan Kemna, U.S. Census Bureau

**The Challenge of Cartographic Design for the Web When Presenting A Plethora of Content: The TIGER Web Experience**

Douglas Lockhart and Stephen Jones, U.S. Census Bureau

**Designing Congressional District Maps**

Michael DeGennaro and Linda Orsini, U.S. Census Bureau

## **REMOTE SENSING III**

*Room: Capitol C*

**Chair:** James A. Lein, Ohio University

### **Preliminary Comparative Analysis of Data Fusion of LIDAR and Optical Imagery for Coastal Vegetation Mapping in South Florida Using an Object-Oriented Approach**

Georgia H. De Stoppelaire, Florida Atlantic University

### **Tree Canopy Foliar Volume from Terrestrial LIDAR Scanner Data**

Clint Harper, Nate Currit, and Jennifer Jensen, Texas State University

### **Maps and Locals: Using Landsat Image Analysis to Document Eastern Red Cedar Expansion in the Northern Flint Hills**

Bryanna Pockrandt, Shawn Hutchinson, and John Harrington, Jr., Kansas State University

## **GEOGRAPHY EDUCATION III: SECONDARY EDUCATION**

*Room: Senate A*

**Chair:** Gillian Acheson, Southern Illinois University Edwardsville

### **The Impact of School District Spending: Exploring the Connection between School District Expenditures and Graduation Rates in Virginia**

Amber Boykin, Michael Gaskins, Sarah Jackson, Christine McDonnell, and Michael L. Mann, George Washington University

### **Community Geography's Potential for Broadening Participation in Geographic Research**

Timothy L. Hawthorne, Georgia State University

### **Teacher Preparation in Geography: An Illinois Case Study**

Gillian Acheson, Southern Illinois University Edwardsville

### **Area Suitability of Public School Development in West Sulawesi Province, Indonesia**

Rasyiddin Azhar and Heru Purwanto, University of Indonesia, Indonesia

## **URBAN GEOGRAPHY III: HOUSING ISSUES**

*Room: Senate B*

**Chair:** Michael M. Mann, George Washington University

### **Using Near Repeat Analysis for Measuring Housing Problems: Examples with Foreclosures and Housing Choice Voucher Relocations**

Ronald Wilson, US Department of Housing and Urban Development and University of Maryland, Baltimore County

### **Demographic Changes and Gentrification in Washington, DC**

Cinthia Josette Arévalo, Bálint Pető, Agustina Suaya, and Michael M. Mann, George Washington University

### **Modeling Residential Development of California: Wildland Encroachment 1999-2049**

Michael L. Mann, Peter Berck, Max Moritz, Enric Batllori, Jamie G. Baldwin, and Dick Cameron, George Washington University

## **SESSIONS F2: 10:30 AM – 12:00 NOON**

### **CLIMATOLOGY III: REGIONAL CLIMATOLOGY**

*Room: Capitol A*

**Chair:** Richard W. Dixon, Texas State University – San Marcos

### **The Influence of Long- and Short-Term Climatic Changes to Chernozem Soils: Central Chernozem Region of Russia**

Yury Belgorod State University, Russia, Anthony Lupo, University of Missouri, Aleksandr Petin and Maria Lebedeva, Belgorod State University, Russia

### **Sultry Charm City: Shifting Probabilities of Hot Days in the Baltimore Metropolitan Area - 1899 to 2012**

Kent Barnes, Towson University

### **Preliminary Analysis of the Synoptic-Scale Environment Associated with Tornado Clusters Produced by Tropical Cyclones in the United States, 1995-2010**

Tood W. Moore, Towson University and Richard W. Dixon, Texas State University - San Marcos

### **New Insight into Colorado's Lightning Climatology: The Influence of Elevation and Terrain Features**

Brandon J. Vogt, University of Colorado Colorado Springs and Steven Hodanish, NOAA/National Weather Service

### **CENSUS BUREAU DEMOGRAPHIC AND GEOGRAPHIC ANALYSIS**

*Room: Capitol B*

**Organizer and Chair:** Michael Ratcliffe, US Census Bureau

### **Accessing and Analyzing Migration Flows Using the Census Flows Mapper**

Melanie A. Rapino, U.S. Census Bureau



## **A Geographic Analysis of Address Change during the 2010 Census Update-Leave Operation**

Sally Snodgrass, U.S. Census Bureau

## **Race, Ethnicity, Place and the 2010 Census: An Investigation into the Character of Places Delineated for the 2010 Census**

Joshua J. Coutts, U.S. Census Bureau

## **Census Geographic and Demographic Information for Colonias**

Michael Ratcliffe, U.S. Census Bureau

## **GIS IV: TRANSPORTATION**

*Room: Capitol C*

**Chair:** Kang Shou Lu, Towson University

## **Using ArcGIS Network Analyst for Criterion-Based Bicycle Route Selection on Existing Road Networks**

Kathleen D. Seal, Texas State University - San Marcos

## **Building a Social Network Platform for Collecting Geographic Information of the Unsheltered Homeless Population**

Chen Xu and David W. Wong, George Mason University

## **Expedition Altai: An Interdisciplinary Quest to Uncover Ancient Migration Routes in an Asian Frontier**

James P. Phillips, East Tennessee University

## **Comparing Two Models That Estimate Carbon Sequestration Ecosystem Service Value**

Carly Dean and Kang Shou Lu, Towson University

## **URBAN GEOGRAPHY IV: PLANNING ISSUES**

*Room: Senate A*

**Chair:** Mark A. Blumler, Binghamton University

## **Planning or Predation? The Story of a Special Purpose District in Texas**

James Vaughan, University Texas at San Antonio

## **Urban Expansion and Environment Parameters: A Case Study of Huntsville, Alabama**

Mahjabin Rahman, Chandana Mitra, and Luke J. Marzen, Auburn University

## **Urban Planning for Biodiversity Conservation**

Mark A. Blumler, Binghamton University

## **HEALTH GEOGRAPHY III: REGIONAL STUDIES**

*Room: Senate B*

**Chair:** Wei Song, University of Louisville

### **HIV/AIDS in Botswana: Factors Influencing the Disparity between Illness and Treatment-Seeking Behavior**

M. Bene, Binghamton University

### **Years of Potential Life Lost for 2010, Mahoning County, Ohio**

Lashale Pugh, Youngstown State University

### **Application of GIS as A Fundamental Tool in Polio Eradication in Nigeria**

Oluwaseun Egbinola, University of Ibadan, Nigeria

### **Area Health Disparities Based on Death Certificates: A Case Study of Census Tracts in Summit County, Ohio**

Gordon A. Cromely, Mohammad Al Nasrallah, Jay Lee, and Heather Beard, Kent State University

## **SESSION F3: 2:30 PM – 3:40 PM**

## **PANEL SESSION**

### **Beyond the Ivory Tower: Applied Careers for Geographers**

*Room: Capitol A*

**Moderators:** Joy K. Adams and Michael Solem, Association of American Geographers

#### **Panelists**

Rachel Berndtson, University of Maryland

Kaile Bower, U.S. Census Bureau

Ed Butterworth, CACI International

Larry Carlson, Larry Carlson & Associates

Ellen Foster, University of Mississippi

Johannes Moenius, Institute for Spatial Economic Analysis

Emily Vogt, University of Colorado Colorado Springs

## **SESSION F4: 3:50 PM – 5:00 PM**

### **WORKSHOP**

*Room: Capitol A*

**Preparing Geography Students for the 21st-Century Workforce**

**Moderators:** Joy K. Adams and Michael Solem, Association of American Geographers  
and Cathy Cooper, Independent Scholar

### **BOARD OF DIRECTOR MEETING**

*Room: Senate B*

# BREAKOUT ROOM LAYOUT

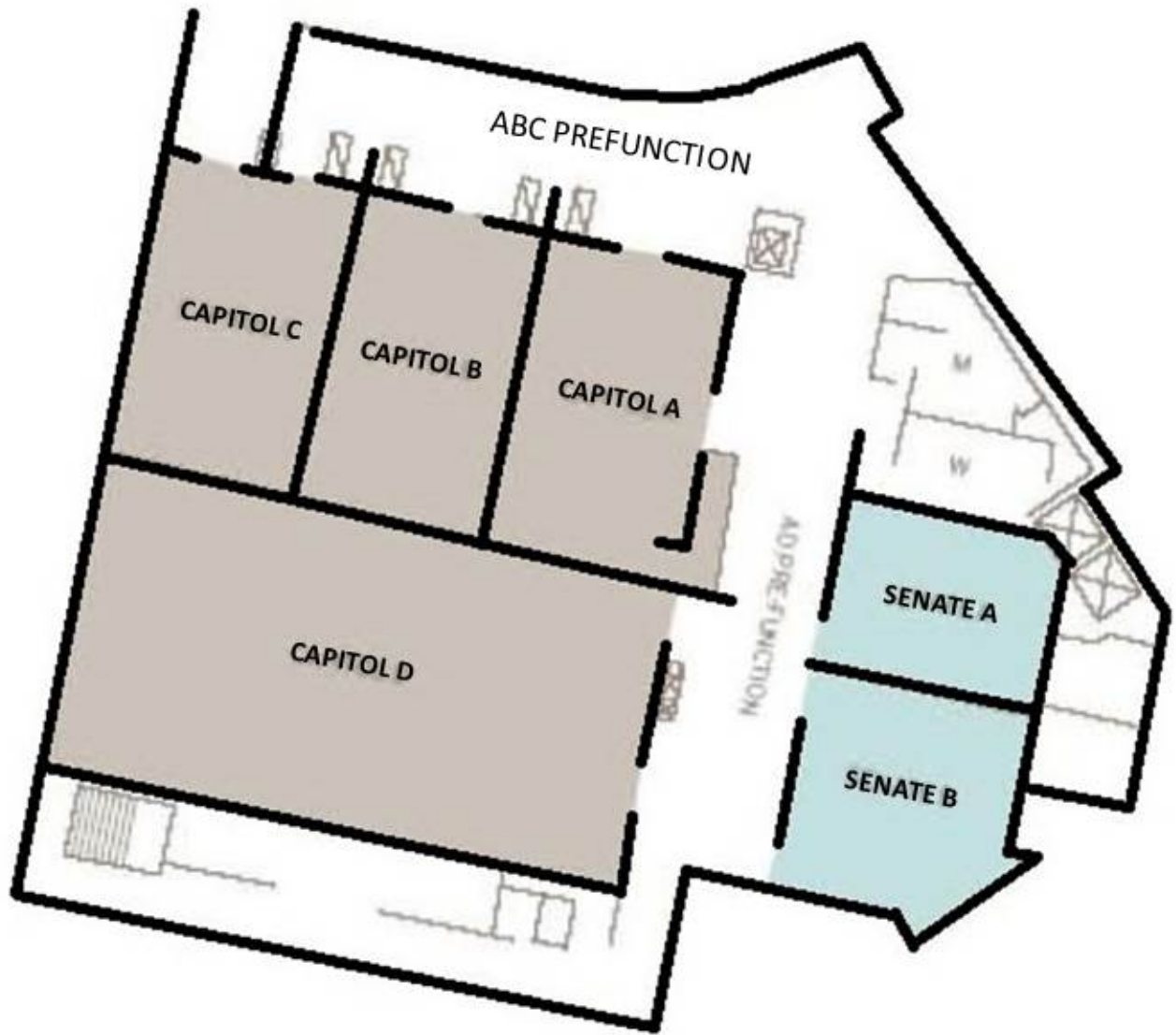

## INDEX

- Acheson, Gillian, 24  
Adams, Joy K., 27, 28  
Aikins, Erick K., 9  
Al Nasrallah, Mohammad, 17, 27  
AlHasem, Ahmed M., 22  
Allbritton, Stacey L., 18  
Alsahli, Mohammad M. M., 22  
Andini, Ajeng Dewi, 20  
Arévalo, Cinthia Josette, 25  
Azhar, Rasyiddin, 24  
Badurek, Christopher A., 7, 8, 16, 23  
Bagchi-Sen, Sharmistha, 11  
Bailey, Timothy J., 18  
Baldwin, Jamie G., 25  
Barnes, Kent, 25  
Batllori, Enric, 25  
Beaird, Heather, 17, 27  
Beck, Richard A., 10  
Belgorod, Yury, 25  
Bender, Michael R., 21  
Bene, M., 27  
Bennett, Jeremy, 10  
Berck, Peter, 25  
Bergstrom, Ryan D., 18  
Berndtson, Rachel, 28  
Bevington-Attardi, Dierdre, 7  
Bhuayn, Istiak A., 18  
Blanchard, R. Denise, 19  
Blue, Sara, 21  
Blumler, Mark A., 27  
Boakye-Danquah, John, 18  
Boehm, Richard G., 8  
Bower, Kaile, 28  
Boykin, Amber, 24  
Brown, Stacey R., 16, 17  
Brysch, Carmen P., 8  
Burger, Paul, 15  
Burns, Lauren, 14  
Butterworth, Ed, 28  
Callahan, Patrick, 17  
Cameron, Dick, 25  
Casey, James K., 9  
Cederholm, Alyson, 18  
Cervone, G., 13  
Chaney, Philip L., 17, 18  
Che, Deborah, 15  
Chloupek, Brett, 15  
Chow, Edwin T., 19, 20  
Christoffel, Thomas J., 10  
Clennon, Eric, 19  
Cockerill, Kristan, 23  
Combs, H. Jason, 15  
Comer, Jonathan C., 20  
Cooper, Cathy, 28  
Coutts, Joshua J., 26  
Cromely, Gordon A., 27  
Currit, Nate, 24  
Curtis, Andrew, 8  
De Stoppelaire, Georgia H., 24  
Dean, Carly, 26  
Dede-Bamfo, Nathaniel, 20  
DeGennaro, Michael, 24  
Devadoss, Christabel, 21  
Diallo, Yasmin, 16

Dixon, Richard W., 9, 25  
Dock, Joel P., 14  
Du, Paul, 17  
Duarte, Adam, 8  
Dunham, Ian M., 10  
Earl, Richard A., 23  
Egbinola, Oluwaseun, 27  
Evans, Aaron, 13  
Faas, A. J., 15  
Fajri, M. Ramdhani, 13  
Flores-Ortiz, Harrison W., 20  
Forbes, Dolores Jane, 10  
Forsyth, Riley, 9  
Foster, Alec, 9  
Foster, Ellen, 28  
Frazier, John W., 14, 16, 18, 19, 21  
French, Jeffrey C., 8  
Gares, Christine, 13  
Gaskins, Michael, 24  
Gatrell, Jay D., 10  
Goddard, Lauren E., 10  
Goworowska, Justyna, 7  
Graham, Matt, 7  
Gritzner, Janet, 13, 14  
Groff Liz, 12  
Hale, Robin, 23  
Hanson, Katherine J., 18  
Hare, Timothy S., 11  
Harper, Clint, 24  
Harrington, John, Jr., 9, 24  
Harrington, Lisa M. B., 19  
Hatchard, Geoff, 7  
Hawthorne, Timothy L., 24  
Heard, Kevin, 21  
Heintzelman, Dan, 10  
Henry, Norah F., 14  
Hernandez, Tony, 14, 17  
Hildebrandt, Mark L., 20  
Hill, Arleen A., 10  
Hinojosa, Jennifer, 19  
Hodanish, Steven, 26  
Holmes, Melissa, 21  
Holst, Heather, 19  
Hooey, Catherine A., 18  
Hudak, Paul, 23  
Huebner, Donald J., 18  
Hug, Andy, 8  
Hutchins, Maya G., 16  
Hutchinson, Shawn, 24  
Irvin, Sandra, 8  
Jackson, Sarah, 24  
Jennings, Steve, 21  
Jensen, Jennifer, 24  
Jensen, Jennifer L. R., 8  
Johnson, Nicole, 11  
Jones, Eric C., 15  
Jones, Stephen, 23  
Joseph, Lawrence, 17  
Kaplan, David H., 18, 21  
Kelly, Jessica J., 8  
Kemna, Ryan, 23  
Khadem, Nashid Kamal, 18  
Khanna, Sumit, 10  
Kidd, Sara, 11  
Kim, Hyun Joong, 8  
Kiskowski, William Louie, 14  
Kusek, Weronika, 19  
Laingen, Chris, 20, 21

Lash, Jeff, 8  
Lebedeva, Maria, 25  
Lee, Jay, 17, 27  
Lein, James, 15  
Lein, James A., 24  
Li, Yingru, 8, 13  
Linsenmeyer, Thomas, 18  
Liu, Zhongwei, 13  
Lockhart, Douglas, 23  
Logue, Everett, 17  
Lombard, John R., 11  
Lu, Kang Shou, 18, 26  
Lupo, Anthony, 25  
Lussenden, Holly, 15  
Mahabir, Ron, 11  
Mann, Michael L., 24, 25  
Mann, Michael M., 25  
Markwith, Scott H., 7  
Marzen, Luke, 8  
Marzen, Luke J., 27  
Mathews, Adam J., 14  
McBride, Alex, 20  
McCarty, Chris, 15  
McDonald, M. Victoria, 9  
McDonnell, Christine, 24  
McGovern, Brendan, 19  
McGregor, Kent, 11  
McLeod, George, 11  
Millett, Bruce V., 14  
Mitchell, Christine, 16  
Mitra, Chandana, 8, 27  
Moenius, Johannes, 10, 28  
Mohler, Rhett L., 21  
Montz, Burrell A., 13  
Moore, Tood W., 25  
Moritz, Max, 25  
Morton, Thomas, 23  
Mufidatunnisa, Nur, 20  
Mukherjee, Falguni, 11  
Munro-Stasiuk, Mandy, 8  
Murphy, Arthur D., 15  
Nations, Robert D., Jr., 10  
Newberry, Jay, 14, 16, 18, 21  
Ornelas, Roxanne T., 14  
Orsini, Linda, 24  
Oxendine, C., 13  
Padgett, David A., 17  
Parr, David A., 10  
Parylak, Rebecca, 9  
Pattern, Matthews T., 14  
Paulika, Marius, 9  
Pearson, Brooks C., 9  
Perry, Marc, 7  
Petin, Aleksandr, 25  
Petó, Bálint, 25  
Phillips, James P., 26  
Pitts, Kristin, 18  
Pockrandt, Bryanna, 24  
Pugh, Lashale, 27  
Purwanto, Heru, 24  
Rae, Robyn, 15  
Raghavan, Ram, 9  
Rahman, Mahjabin, 27  
Rahman, Munshi Khaledur, 8  
Rajendran, Vijayaprabha, 11  
Rao, P. Jagadeeswara, 14  
Rapino, Melanie A., 26  
Rapp, Charles, 23

Ratcliffe, Michael, 7, 23, 26

Renaully, Mia, 13

Rettig, Andrew J., 10

Reynolds, Jerry, 9

Rice, Murray D., 14, 17, 19, 20

Rohmah, Fathu, 13

Rybarczyk, Greg, 21

Saku, James C., 14

Sanchez-Rivera, Ana I., 16

Sandifer, Jeremy, 20

Sansom, Lindsay, 7

Schmidlin, Thomas, 8

Schnebele, Emily, 13

Scholz, Michael, 10

Schwartz, David, 18

Scott, Michael S., 13

Seal, Kathleen D., 26

Shaker, Richard R., 11, 23

Sheers, Sinclair, 11

Shunn, Breanna, 18

Smith, Meghan, 7

Smith, Porsha, 11

Snodgrass, Sally, 26

Solem, Michael, 27, 28

Song, Wei, 14, 27

Suaya, Agustina, 25

Tabor, Lisa K., 19

Tampubolon, Eva Sari, 19

Tang, Quan, 15

Taylor, Emariana, 19

Taylor, Shannon V., 18

Thebpanya, Paporn, 19

Tobin, Graham A., 9, 13, 15

Tolessa, G. Ashenafi, 14

Trgovac, Andrew B., 11

Uddin-Ahmed, Syed S., 21

Vaughan, James, 27

Verma, Kanika, 20

Vogt, Brandon J., 26

Vogt, Emily, 28

Waldron, Brian A., 10

Wang, Fahui, 15

Wang, Lei, 15

Waters, N., 13

Weaver, Greg S., 18

Wells, Chad, 11

Whiteford, Linda M., 15

Wikle, Thomas A., 20

Wilson, Ronald, 15, 16, 25

Wilson-Chavez, Owen, 17

Wiradharma, Dhaniswara, 19

Wong, David W., 26

Wright, Rose, 15

Xie, Zixiao, 13

Xu, Chen, 26

Yarbrough, Trevor, 14

Yeates, Maurice, 17

Youngblood, Susan A., 18

Zhang, Charlie H., 16, 21

Zhao, Xin, 17

Zhou, Yu, 19

Zubalsky, Sara L., 11



The 37<sup>th</sup> Annual

***Applied Geography Conference***

October 21 – 23, 2014

**Hilton Atlanta**

255 Courtland Street

Atlanta, GA 30303

(404) 221-6238

<http://atlanta.hilton.com>